

Synergy Enclosures

AFTERCARE AND MAINTENANCE CHECKS

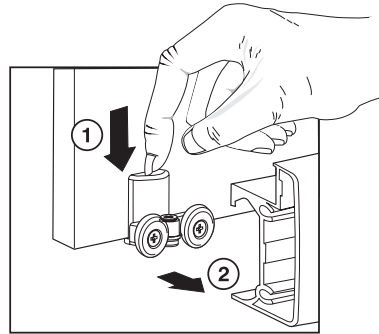

Click & Clean Wheels



- Enclosures with sliding doors feature 'click and clean' wheels.
- This feature has been designed to allow easier cleaning for the end user. It means that the wheels that sit inside the bottom rail of the profile (as pictured) can be dis-engaged to allow the door to be gently pushed away from the profile, allowing better access for cleaning those hard to reach places.
- When cleaning is complete it is imperative that the wheels are completely re-engaged into the bottom rail. A physical check rather than just visual should be conducted. The doors should once again run smoothly and completely within the bottom rail.
- **Never operate a sliding shower door when only the top wheels are engaged in the rail!**

Waste Maintenance

- Remove dome (if applicable).
- Remove grid by gently pulling upwards.
- Remove any debris (hair etc.) from the grid.
- Check the container with water in is free from dirt, hair etc. Remove and empty if not. (This is the water seal, fill it up again after cleaning).
- Replace the grid.
- Replace the dome (if applicable).
- Avoid the use of chemicals (bleach etc.) as this will affect the appearance of chrome plated parts and also may affect the performance of the waste.

Glass Care and Maintenance



Your Ideal Standard enclosure features 'Ideal Clean' glass. This is a coating on the inside of your enclosure which makes the glass easier to clean.

We recommend the following cleaning instructions for your enclosure and shower tray:

After use, the showering area should be cleaned with soap and water, this includes door seals. This is particularly important in hard water areas where insoluble lime salts may be deposited and allowed to build up.

Cleaners and cloths of a gritty or abrasive nature should not be used. Care should be taken to avoid contact with strong chemicals such as organic solvents and strippers.

Glass cleaners can be used but with caution so as to not damage the Ideal Clean coating, if in doubt, contact the manufacturer of the cleaner in question.

Our enclosures and bath screens have a 10 year guarantee against manufacturing defects. They are manufactured using the highest quality materials, are subject to rigorous testing and quality standards and are compliant and marked with the mandatory EN and CE regulation marque. We have confidence that if installed correctly, cared for appropriately and are used in a manner for which they are intended, our products will offer you and your family years of hassle free enjoyment and use. As with any glass product, in the unlikely event that you are concerned about its safety or functionality, it is important to seek guidance.

If you have any such concerns regarding your enclosure please contact Ideal Standard customer care department:

Customercare@idealstandard.com

Spare parts, including replacement seals can also be obtained on our fast parts website: **www.fastparts.co.uk**



Ideal Standard